

The powerful solution to all heavy duty drive problems

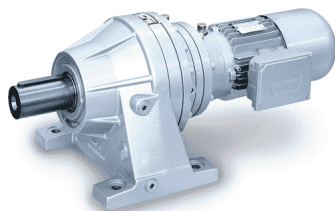

Compact, and yet extremely powerful, are the units of the 300 series. Their planetary drive train makes them the ideal choice for all the severe duty applications where shock loadings and impacts are more the rule than the exception. The product configuration is highly versatile, due to several options as far as the mounting, the gear layout, the output shaft and the motor interface. All the features are available for each of the 18 finely spaced frame sizes, spanning over the 1.000 - 1.400.000 Nm torque range. Finding the perfect match to any drive problem is therefore more than a wish, it is something users can safely rely on - always.

Type	Torque Nm
300	1.000
301	1.750
303	2.500
304	3.600
305	5.000
306	8.500
307	12.500
309	18.000
310	25.000
311	40.000
313	55.000
314	80.000
315	100.000
316	135.000
317	170.000
318	250.000
319	350.000
321	500.000
323	800.000
325	1.100.000

Technical data

Torque Range

1000 - 1.400.000 Nm

Mechanical Rating (n1= 1400 min-1)

up to 450 kW

Gear ratio

3.4 to 5.000

Gear Unit Version

In line

Right angle (with Gleason bevel gear set)

Output

Foot and flange mounted

Output shaft: keyed solid, splined, splined hollow

hollow shaft with shrink disc

Input

IEC and NEMA motor adaptors

Solid input shaft with or without fan cooling - inch or metric dims.

Applicable AC motors

Compact motors and brake motors M series

IEC motors and brake motors BN series

Single and dual speed motors

Main Brake Features

DC and AC supply

Faster brake reaction through electronically controlled rectifier

Main Motor Options

Thermistors and thermostatic sensor

Independent forced cooling

Line driver and push-pull incremental encoder

Downloads



[Catalog](#)



[Manual](#)